

The Superiority of Lateral Mobile Shelving

Before...

After...

Scenario One

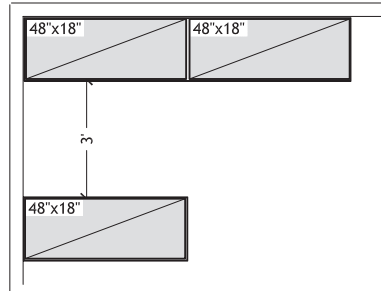

30 Square Feet Required

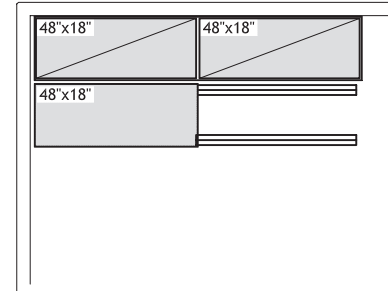

24 Square Feet Required

Mobile Storage reduces are required by 6 square feet or 20% reduction in space

Scenario Two

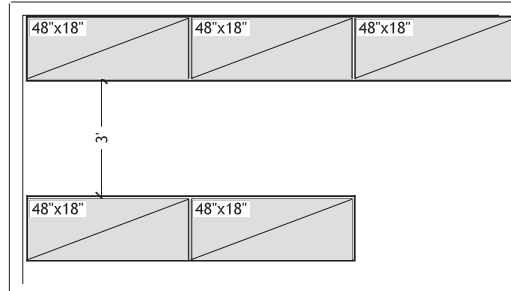

54 Square Feet Required

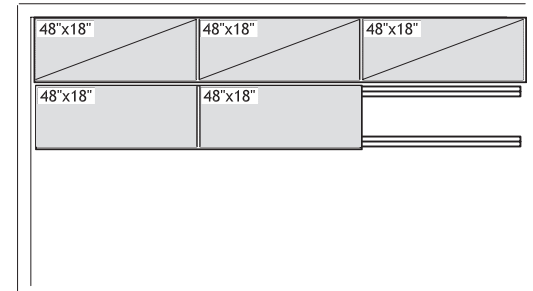

36 Square Feet Required

Mobile Storage reduces are required by 18 square feet or 33% reduction in space

Scenario Three

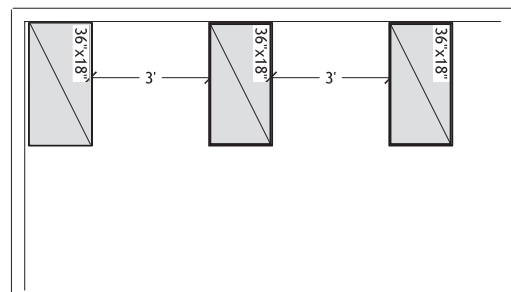

31.5 Square Feet Required

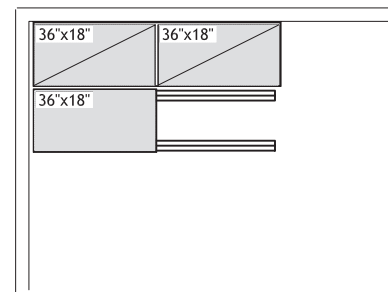

18 Square Feet Required

Mobile Storage reduces are required by 13.5 square feet or 43% reduction in space

The Superiority of Compacting Mobile Shelving

Before...

After...

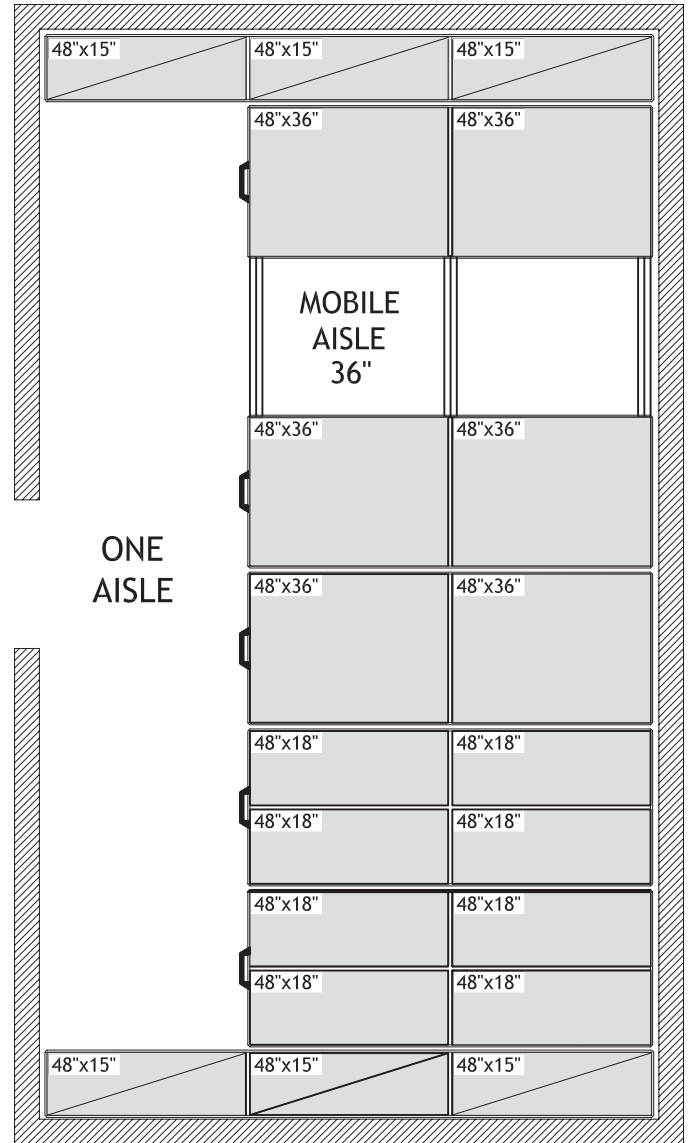
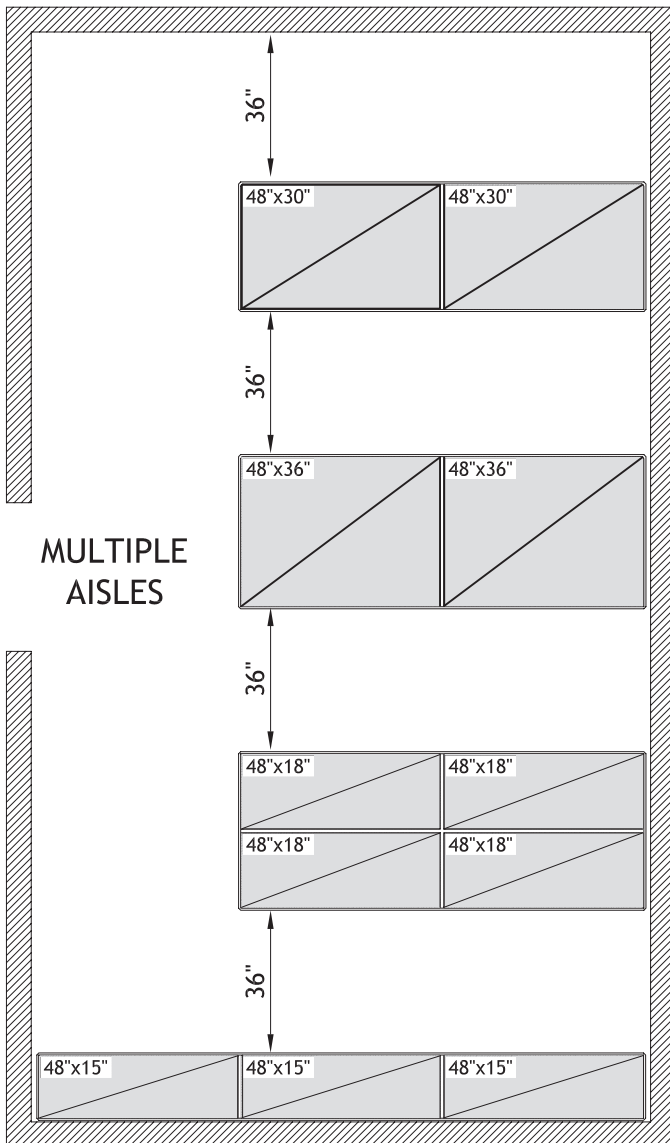

Static Shelving Option

83 Square Feet of Storage

45% Decrease Over Mobile Shelving Option

Mobile Compacting Shelving Option

150 Square Feet of Storage

80% Increase Over Static Shelving Option